

76829-0006 SHOWN

NOTES:

- MATERIAL:
HOUSING: LCP, UL94V-0, GLOW WIRE CAPABLE PER IEC-60335-1 5TH EDITION, COLOR: BLACK.
TERMINAL: HIGH CONDUCTIVITY COPPER.
- TERMINAL PLATING:
(TIN) 1.52 MICROMETER /(60 MICROINCH) MIN REFLOWED MATTE TIN OVER
1.27 MICROMETER /(50 MICROINCH) MIN NICKEL OVERALL.
(15 GOLD) 0.38 MICROMETER /(15 MICROINCH) MIN SELECT GOLD ON CONTACT AREA
2.54 MICROMETER /(100 MICROINCH) MIN SELECT MATTE TIN ON SOLDER AREA
BOTH OVER 1.27 MICROMETER /(50 MICROINCH) MIN NICKEL OVERALL
(30 GOLD) 0.76 MICROMETER /(30 MICROINCH) MIN SELECT GOLD ON CONTACT AREA
2.54 MICROMETER /(100 MICROINCH) MIN SELECT MATTE TIN ON SOLDER AREA
BOTH OVER 1.27 MICROMETER /(50 MICROINCH) MIN NICKEL OVERALL
- PRODUCT SPECIFICATION PS-76823-100, 1720631000-PS
- PART MATES WITH MOLEX PART NUMBER 170001 AND 171692 SERIES.
- PACKAGING: TRAY PACKED PER MOLEX SPECIFICATION PK-31301-976, WHILE T&R IS 1720650900.
- APPLICATION SPECIFICATION: AS-76823-100, 768232000-AS
- PARTS CONFORM TO CLASS "B" REQUIREMENTS OF COSMETIC SPECIFICATION PS-45499-002.

MODEL: 768290000

FUNCTIONAL SYMBOLS	THIS DRAWING CONTAINS INFORMATION THAT IS PROPRIETARY TO MOLEX ELECTRONIC TECHNOLOGIES, LLC AND SHOULD NOT BE USED WITHOUT WRITTEN PERMISSION			
	DIMENSION UNITS	SCALE		CURRENT REV DESC:
$\frac{F}{A} = 0$	INCH	2:1		EC NO: 652126 DRWN: ALU002 CHK'D: YXZHENG APPR: YXZHENG
$\frac{F}{C} = 0$	GENERAL TOLERANCES (UNLESS SPECIFIED)			
DIVISIONAL SYMBOLS		MM	INCH	2020/12/28
	4 PLACES	±	±	2020/12/28
	3 PLACES	±	±	2020/12/28
	2 PLACES	± 0.25	±	2020/12/28
	1 PLACE	± 0.5	±	INITIAL REVISION:
	0 PLACES	±	±	DRWN: DRAWN BY
	ANGULAR TOL	± 0.5 °		APPR: APPR BY
	DRAFT WHERE APPLICABLE MUST REMAIN WITHIN DIMENSIONS	THIRD ANGLE PROJECTION	DRAWING	SERIES
			C-SIZE	76829
DOCUMENT STATUS		P1	RELEASE DATE	2020/12/28 07:49:13
DOCUMENT NUMBER		CUSTOMER		SHEET NUMBER
SD-76829-0100		GENERAL MARKET		1 OF 3

molex

MEGA-FIT VERTICAL HEADER
VERTICAL HEADER ASSY 2-12 CKT TOP LATCH

PRODUCT CUSTOMER DRAWING

DOCUMENT NUMBER: SD-76829-0100
DOC TYPE: PSD
DOC PART: 000
REVISION: E

MATERIAL NUMBER: GENERAL MARKET
CUSTOMER: GENERAL MARKET
SHEET NUMBER: 1 OF 3

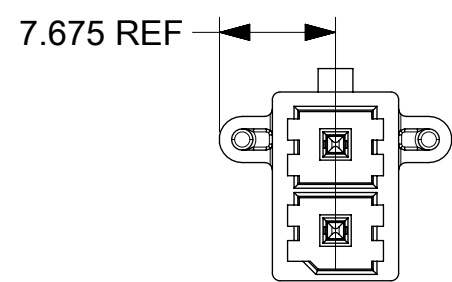

2 CKT

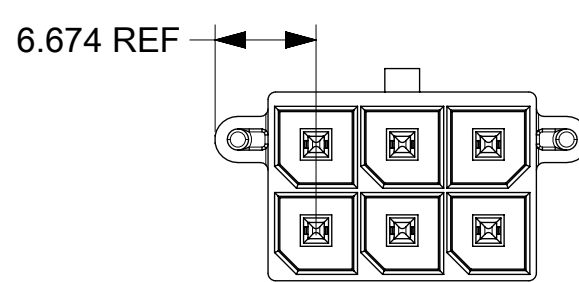

4-12 CKT

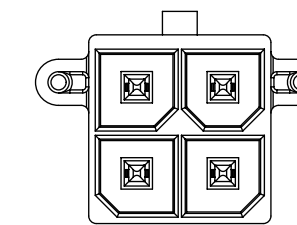

4 CKT

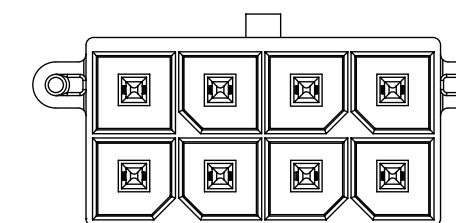

8 CKT

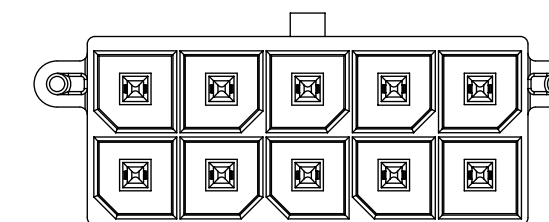

10 CKT

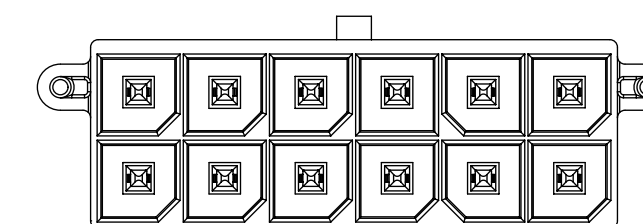

12 CKT

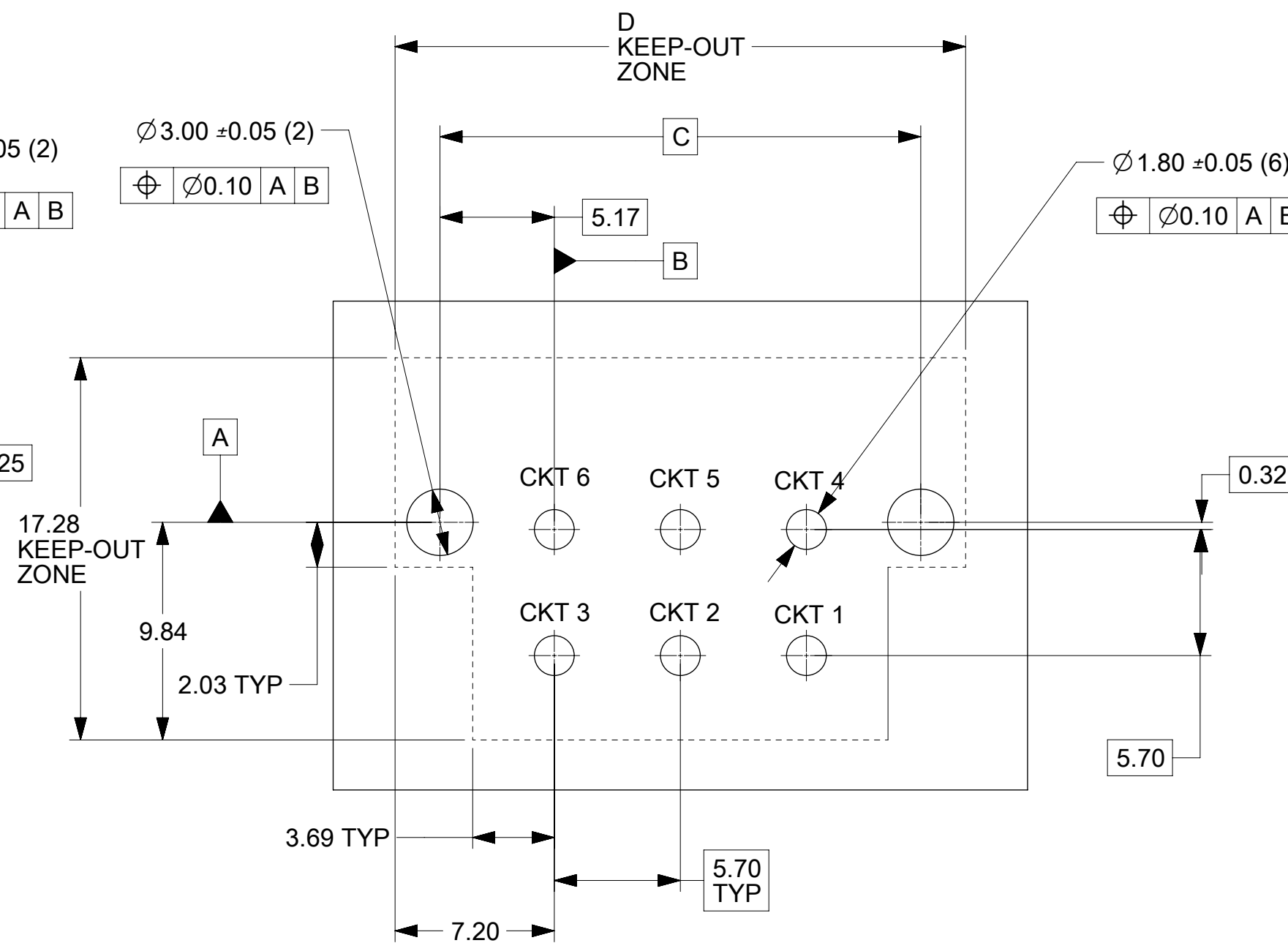
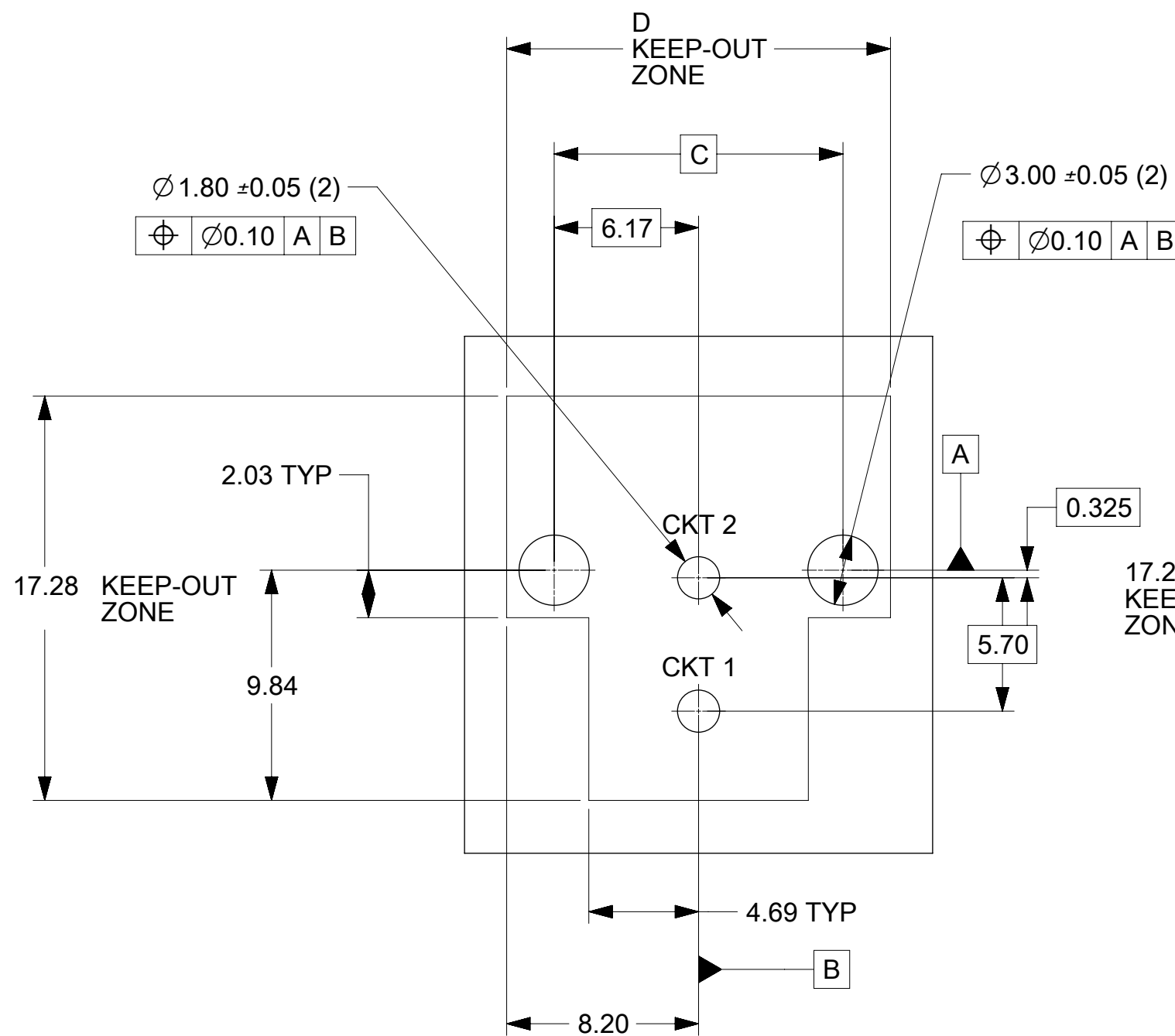

PCB LAYOUT: COMPONENT SIDE
RECOMENDED PCB THICKNESS: 1.58 MM/.062 IN TO 2.36 MM/.093 IN

PCB LAYOUT: COMPONENT SIDE
RECOMENDED PCB THICKNESS: 1.58 MM/.062 IN TO 2.36 MM/.093 IN

FUNCTIONAL SYMBOLS $\frac{F}{A} = 0$ $\frac{F}{C} = 0$ $\frac{F}{P} = 0$ DIVISIONAL SYMBOLS	THIS DRAWING CONTAINS INFORMATION THAT IS PROPRIETARY TO MOLEX ELECTRONIC TECHNOLOGIES, LLC AND SHOULD NOT BE USED WITHOUT WRITTEN PERMISSION		CURRENT REV DESC:		
	DIMENSION UNITS	SCALE	EC NO: 652126		
	INCH	4:1	DRWN: ALU002 2020/12/28		
	GENERAL TOLERANCES (UNLESS SPECIFIED)		CHK'D: YXZHENG 2020/12/28		
	MM	INCH	APPR: YXZHENG 2020/12/28		PRODUCT CUSTOMER DRAWING DOCUMENT NUMBER: SD-76829-0100 DOC TYPE: PSD DOC PART: 000 REVISION: E
4 PLACES	±	±	INITIAL REVISION:		
3 PLACES	±	±	DRWN: DRAWN BY 0099/99/99		
2 PLACES	±	0.25 ±	APPR: APPR BY 0099/99/99		
1 PLACE	±	0.5 ±	DRAFT WHERE APPLICABLE MUST REMAIN WITHIN DIMENSIONS		
0 PLACES	±	±	THIRD ANGLE PROJECTION		
ANGULAR TOL	±	0.5 °	DRAWING	SERIES	MATERIAL NUMBER
			C-SIZE	76829	CUSTOMER
					GENERAL MARKET
					SHEET NUMBER
					2 OF 3

12	11	10	9	8	7	6	5	4	3	2	1	
CKT SIZE	PART NO.	PLATING	DIM A	DIM B	DIM C BASIC	DIM D	PK SPEC					
2	76829-0002	TIN	8.35	15.39	12.34	16.40	TRAY					
4	76829-0004	TIN	12.05	19.09	16.04	20.10						
6	76829-0006	TIN	17.75	24.79	21.74	25.80						
8	76829-0008	TIN	23.45	30.49	27.44	31.50						
10	76829-0010	TIN	29.15	36.19	33.14	37.20						
12	76829-0012	TIN	34.85	41.89	38.84	42.90						
2	172065-0002	15 GOLD	8.35	15.38	12.34	16.40						
4	172065-0004	15 GOLD	12.05	19.09	16.04	20.10						
6	172065-0006	15 GOLD	17.75	24.79	21.74	25.80						
8	172065-0008	15 GOLD	23.45	30.49	27.44	31.50						
10	172065-0010	15 GOLD	29.15	36.19	33.14	37.20						
12	172065-0012	15 GOLD	34.85	41.89	38.84	42.90						
2	172065-1002	30 GOLD	8.35	15.38	12.34	16.40						
4	172065-1004	30 GOLD	12.05	19.09	16.04	20.10						
6	172065-1006	30 GOLD	17.75	24.79	21.74	25.80						
8	172065-1008	30 GOLD	23.45	30.49	27.44	31.50						
10	172065-1010	30 GOLD	29.15	36.19	33.14	37.20						
12	172065-1012	30 GOLD	34.85	41.89	38.84	42.90						

12	11	10	9	8	7	6	5	4	3	2	1	
CKT SIZE	PART NO.	PLATING	DIM A	DIM B	DIM C BASIC	DIM D	PK SPEC					
2	76829-0902	TIN	8.35	15.38	12.34	16.40	TAPE&REEL WITHOUT KAPTON					
4	76829-0904	TIN	12.05	19.09	16.04	20.10						
6	76829-0906	TIN	17.75	24.79	21.74	25.80						
8	76829-0908	TIN	23.45	30.49	27.44	31.50						
10	76829-0910	TIN	29.15	36.19	33.14	37.20						
12	76829-0912	TIN	34.85	41.89	38.84	42.90						
2	172065-0902	15 GOLD	8.35	15.38	12.34	16.40						
4	172065-0904	15 GOLD	12.05	19.09	16.04	20.10						
6	172065-0906	15 GOLD	17.75	24.79	21.74	25.80						
8	172065-0908	15 GOLD	23.45	30.49	27.44	31.50						
10	172065-0910	15 GOLD	29.15	36.19	33.14	37.20						
12	172065-0912	15 GOLD	34.85	41.89	38.84	42.90						
2	172065-1902	30 GOLD	8.35	15.38	12.34	16.40						
4	172065-1904	30 GOLD	12.05	19.09	16.04	20.10						
6	172065-1906	30 GOLD	17.75	24.79	21.74	25.80						
8	172065-1908	30 GOLD	23.45	30.49	27.44	31.50						
10	172065-1910	30 GOLD	29.15	36.19	33.14	37.20						
12	172065-1912	30 GOLD	34.85	41.89	38.84	42.90						
*	2	76829-0702	TIN	8.35	15.38	12.34		16.40	TAPE&REEL WITH KAPTON			
*	4	76829-0704	TIN	12.05	19.09	16.04		20.10				
*	6	76829-0706	TIN	17.75	24.79	21.74		25.80				
*	8	76829-0708	TIN	23.45	30.49	27.44		31.50				
*	10	76829-0710	TIN	29.15	36.19	33.14		37.20				
*	12	76829-0712	TIN	34.85	41.89	38.84		42.90				
*	2	172065-0702	15 GOLD	8.35	15.38	12.34	16.40					
*	4	172065-0704	15 GOLD	12.05	19.09	16.04	20.10					
*	6	172065-0706	15 GOLD	17.75	24.79	21.74	25.80					
*	8	172065-0708	15 GOLD	23.45	30.49	27.44	31.50					
*	10	172065-0710	15 GOLD	29.15	36.19	33.14	37.20					
*	12	172065-0712	15 GOLD	34.85	41.89	38.84	42.90					
*	2	172065-1702	30 GOLD	8.35	15.38	12.34	16.40					
*	4	172065-1704	30 GOLD	12.05	19.09	16.04	20.10					
*	6	172065-1706	30 GOLD	17.75	24.79	21.74	25.80					
*	8	172065-1708	30 GOLD	23.45	30.49	27.44	31.50					
*	10	172065-1710	30 GOLD	29.15	36.19	33.14	37.20					
*	12	172065-1712	30 GOLD	34.85	41.89	38.84	42.90					

* DESIGNATES PART NOT RELEASED
CONTACT FACTORY FOR AVAILABILITY.

MODEL: 768290000

FUNCTIONAL SYMBOLS FA = 0 FC = 0 FP = 0 DIVISIONAL SYMBOLS	THIS DRAWING CONTAINS INFORMATION THAT IS PROPRIETARY TO MOLEX ELECTRONIC TECHNOLOGIES, LLC AND SHOULD NOT BE USED WITHOUT WRITTEN PERMISSION												
	FUNCTIONAL SYMBOLS FA = 0 FC = 0 FP = 0 DIVISIONAL SYMBOLS	DIMENSION UNITS INCH	SCALE 2:1	CURRENT REV DESC:									
	GENERAL TOLERANCES (UNLESS SPECIFIED)		EC NO: 652126 DRWN: ALU002 CHK'D: YXZHENG APPR: YXZHENG			2020/12/28 2020/12/28 2020/12/28			 MEGA-FIT VERTICAL HEADER VERTICAL HEADER ASSY 2-12 CKT TOP LATCH				
	4 PLACES ± ± 3 PLACES ± ± 2 PLACES ± 0.25 ± 1 PLACE ± 0.5 ± 0 PLACES ± ± ANGULAR TOL ± 0.5 °		INITIAL REVISION: DRWN: DRAWN BY APPR: APPR BY			0099/99/99 0099/99/99						PRODUCT CUSTOMER DRAWING DOCUMENT NUMBER SD-76829-0100	
DRAFT WHERE APPLICABLE MUST REMAIN WITHIN DIMENSIONS		THIRD ANGLE PROJECTION 		DRAWING C-SIZE		SERIES 76829		MATERIAL NUMBER CUSTOMER GENERAL MARKET		DOC TYPE PSD		DOC PART 000	REVISION E

DOCUMENT STATUS	P1	RELEASE DATE	2020/12/28 07:49:13
-----------------	----	--------------	---------------------