

Transmittal, reproduction, dissemination and/or editing of this document as well as utilization of its contents and communication thereof to others without express authorization are prohibited.
未经允许禁止传输、复制、编辑该文档，以及利用其内容进行交流

REVISION RECORD				
REV	CN	DESCRIPTION	DRFT	DATE

General information:

1. Material: Aluminium die-cast
2. Material, cover: Aluminium die-cast
3. Colour: Grey
4. Surface: Powder-coated
5. Operating temperature: -40°C~+125°C
6. Degree of protection acc.to DIN EN60529 for coupled connector: IP65
7. Outgoing direction: Side outgoing line
8. Locking element:
Locking type: Single locking latch
Material: Metal galvanized/nickel plating
9. Thread size: M/PG
10. Hoods&Housings seal: NBR
11. Undimensioned Tolerances:

Pitch mm	Range In		Nominal Dimension		Range		Tolerance
	TO	TO	TO	TO	TO	TO	
6	±0.15	±0.20	±0.30	±0.50	±0.70	±1.00	±2'

HOW TO ORDER:

S24B-BM-1L.M

- Locking lever — 1L: 1 levers(plastic) 2B: 2 bolts
2L: 2 levers(plastic) 4B: 4 bolts
1L.M: 1 levers(Metal)
2L.M: 2 levers(Metal)
- Housing type — SE: Side entry
SEH: Side entry—high construction
TE: Top entry
TEH: Top entry—high construction
BM: Bulkhead mounted
SM: Suface mounted
SMH: Suface mounted—high construction
CC: Cable to cable
CCH: Cable to cable high construction
- Sereies — S3A: 3A Compact type S6B: 6B Standard type
S10A: 10A Compact type S10B: 10B Standard type
S16A: 16A Compact type S16B: 16B Standard type
S32A: 32A Compact type S24B: S24B Standard type
S32B: S32B Standard type
S48B: S48B Standard type

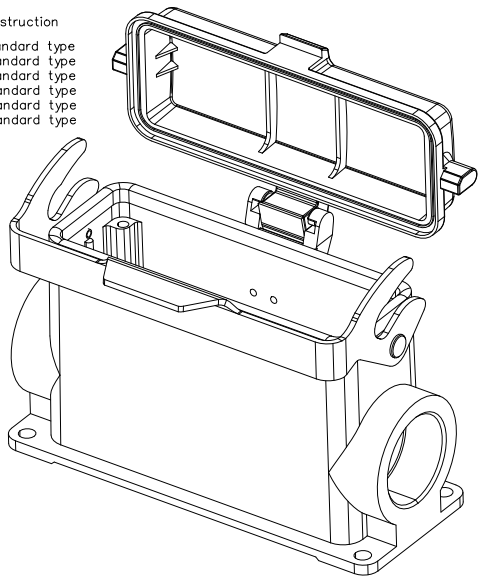
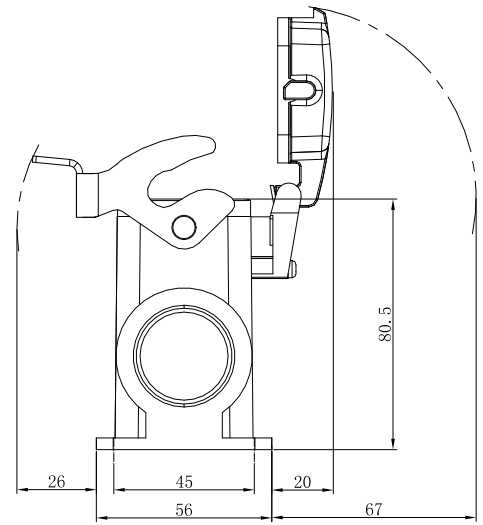
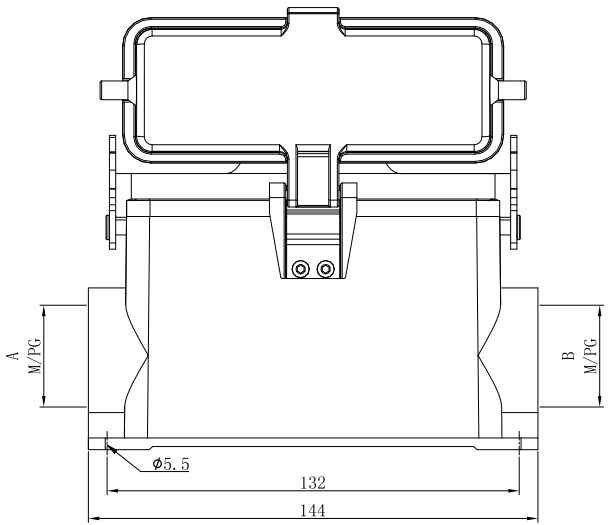

Order number	A	B
S24B-SMH-1L. M-M32-MC	M32×1.5	/
S24B-SMH-1L. M-2M32-MC	M32×1.5	M32×1.5
S24B-SMH-1L. M-PG21-MC	PG21	/
S24B-SMH-1L. M-2PG21-MC	PG21	PG21
S24B-SMH-1L. M-PG29-MC	PG29	/
S24B-SMH-1L. M-2PG29-MC	PG29	PG29

Order No.	Signature	Date	Name	Material	Tolerances Table	Surface
S24B-SMH-1L. M-XXX-MC	CHH	2024.07.19	CHH	S24B表面安装高结构金属单扣底座-XXX-金属盖子	未注公差	表面
Item	CHH	2024.07.19	CHH	/	Revision Number	VDI21
Design	-	-	-	/	Weight	比例
Check	-	-	-	/	Scale	1:1
Process	-	-	-	/	第1页/共1页 1 of 1	mm
Unify	-	-	-	/	SUPU 宁波盛普电子有限公司	
Approve	XJ	2024.07.19	XJ	/	NINGBO SUPU ELECTRONICS CO.,LTD.	

借通用件登记
Common Part

原图号
Old Draw. No.

底图总号
Assembly No.