

# 92 Series - Sockets and accessories for 62 series relays



92.03

Approvals  
(according to type):



Screw terminal (Box clamp) socket panel or 35 mm rail (EN 50022) mount	92.03 (blue)	92.03.0 (black)
For relay type	62.32, 62.33	62.32, 62.33
<b>Accessories</b>		
Metal retaining clip (supplied with socket - packaging code SMA)		092.71
Identification tag		092.00.2
Modules (see table below)		99.02
Timer modules (see table below)		86.00, 86.10, 86.20
<b>Technical data</b>		
Rated values	16 A - 250 V	
Insulation	≥ 6 kV (1.2/50 μs) between coil and contacts	
Protection category	IP 20	
Ambient temperature	°C -40...+70	
⊕ Screw torque	Nm 0.8	
Wire strip length	mm 10	
Max. wire size for 92.03 socket	solid wire	stranded wire
	mm <sup>2</sup>	1x10 / 2x4
	AWG	1x8 / 2x12

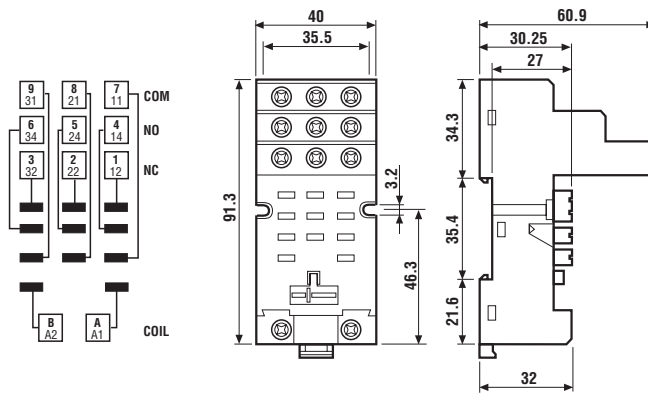

62



86.00



86.10

## 86 series timer modules (see technical data pages 181/182/188)

Multi-voltage: (12...240)V AC/DC; Multi-functions: AI, DI, SW, BE, CE, DE, EE, FE; (0.05s...100h)	86.00.0.240.0000
Mono-function: (12...24)V AC/DC; function AI; (1.5s...60min)	86.10.0.024.0000
Mono-function: (12...24)V AC/DC; function DI; (1.5s...60min)	86.20.0.024.0000

Approvals

(according to type):



99.02

Approvals  
(according to type):



## 99.02 coil indication and EMC suppression modules for 92.03 socket

See technical data pages 247/248		Blue*
Diode (+A1, standard polarity)	(6...220)V DC	99.02.3.000.00
Diode (+A2, non standard polarity)	(6...220)V DC	99.02.2.000.00
LED	(6...24)V DC/AC	99.02.0.024.59
LED	(28...60)V DC/AC	99.02.0.060.59
LED	(110...240)V DC/AC	99.02.0.230.59
LED + Diode (+A1, standard polarity)	(6...24)V DC	99.02.9.024.99
LED + Diode (+A1, standard polarity)	(28...60)V DC	99.02.9.060.99
LED + Diode (+A1, standard polarity)	(110...220)V DC	99.02.9.220.99
LED + Diode (+A2, non standard polarity)	(6...24)V DC	99.02.9.024.79
LED + Diode (+A2, non standard polarity)	(28...60)V DC	99.02.9.060.79
LED + Diode (+A2, non standard polarity)	(110...220)V DC	99.02.9.220.79
LED + Varistor	(6...24)V DC/AC	99.02.0.024.98
LED + Varistor	(28...60)V DC/AC	99.02.0.060.98
LED + Varistor	(110...240)V DC/AC	99.02.0.230.98
RC circuit	(6...24)V DC/AC	99.02.0.024.09
RC circuit	(28...60)V DC/AC	99.02.0.060.09
RC circuit	(110...240)V DC/AC	99.02.0.230.09
Residual current by-pass (62 kΩ/1W)	(110...240)V AC	99.02.8.230.07

\* Modules in Black  
housing are  
available on request.

# 92 Series - Sockets and accessories for 62 series relays



92.13

Approvals  
(according to type):



PCB socket	92.13 (blue)	92.13.0 (blue)
For relay type	62.32, 62.33	62.32, 62.33
<b>Accessories</b>		
Metal retaining clip (supplied with socket - packaging code SMA)	092.54	
<b>Technical data</b>		
Rated values	16 A - 250 V (10 A max for each contact circuit)	
Dielectric strength	≥ 2.5 kV AC	
Ambient temperature	°C -40...+70	

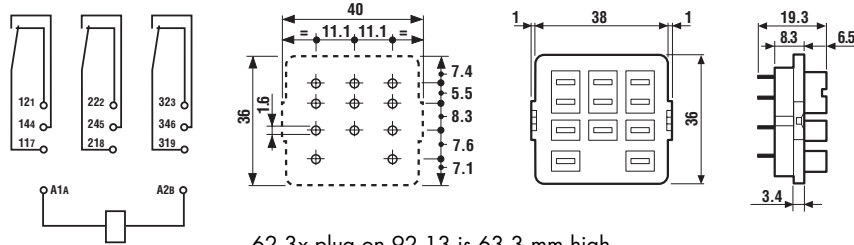

62.3x plug on 92.13 is 63.3 mm high



92.33

Approvals  
(according to type):



Panel mount solder socket mounted with M3 screw	92.33 (blue)
For relay type	62.32, 62.33
<b>Accessories</b>	
Metal retaining clip (supplied with socket - packaging code SMA)	092.54
<b>Technical data</b>	
Rated values	16 A - 250 V (10 A max for each contact circuit)
Dielectric strength	≥ 2.5 kV AC
Ambient temperature	°C -40...+70

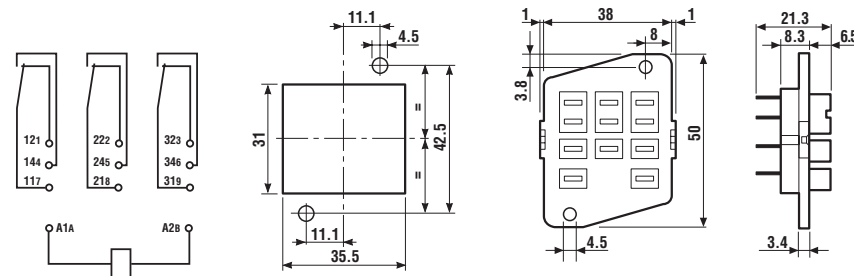

## Packaging code

How to code and identify retaining clip and packaging options for sockets.

Code options according to the last three letters:

9 2 . 0 3 S M A

A Standard packaging

SM Metal retaining clip

9 2 . 0 3 [ ] [ ]

Without retaining clip