

Minibright LED Series

Conventional Part No. Global Part No. Lighting Color
 LN01203C – (L) LNG202C2R Red
 LN01303GC – (L) LNG303M2G Green
 LN01403YC – (L) LNG403N2X Amber

■ 絶対最大定格 Absolute Maximum Ratings (T_a = 25°C)

Lighting Color	P _D (mW)	I _F (mA)	I _{FP} (mA)*	V _R (V)	T _{opr} (°C)	T _{stg} (°C)
Red	40	15	80	4	-25 ~ +85	-30 ~ +100
Green	40	15	80	4	-25 ~ +85	-30 ~ +100
Amber	40	15	80	4	-25 ~ +85	-30 ~ +100

I_{FP}の条件は duty 10% , Pulse width 1 msec. The condition of I_{FP} is duty 10%, Pulse width 1 msec

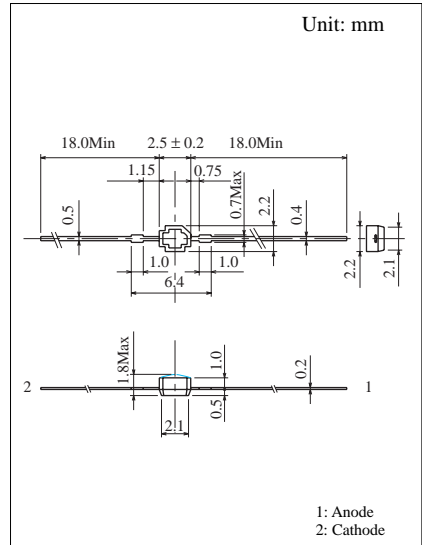

■ 電気的光学的特性 Electro-Optical Characteristics (T_a = 25°C)

Conventional Part No.	Lighting Color	Lens Color	I _O		I _F	V _F		λ _P	Δλ	I _F	I _R	
			Typ	Min		Typ	Max	Typ	Typ		I _F	Max
LN01203C – (L)	Red	Clear	1.4	0.6	10	2.05	2.7	700	100	10	5	4
LN01303GC – (L)	Green	Green Clear	5.0	2.0	10	2.05	2.7	565	30	10	10	4
LN01403YC – (L)	Amber	Amber Clear	1.0	0.4	10	2.00	2.7	590	30	10	10	4
Unit	—	—	mcd	mcd	mA	V	V	nm	nm	mA	μA	V

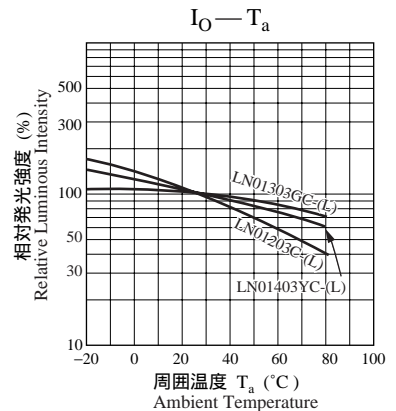
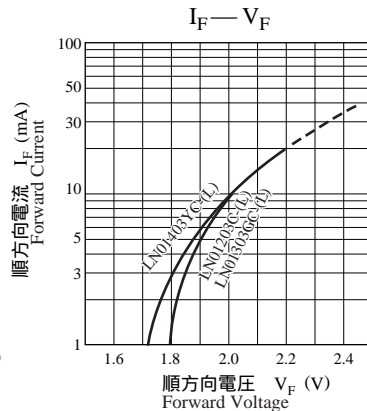
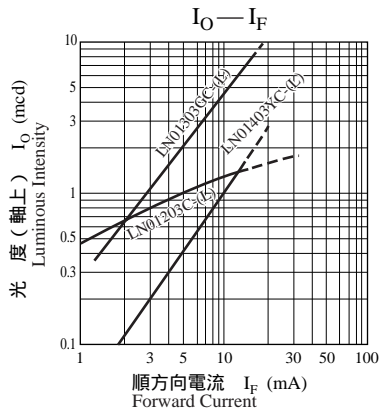

相对発光強度 — 波長特性
 Relative Luminous Intensity
 Wavelength Characteristics

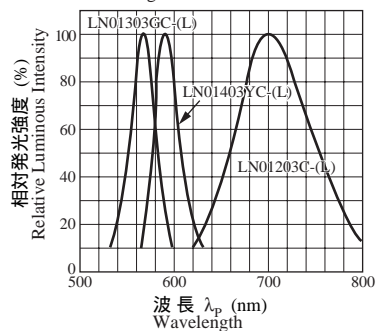

指向特性
 Directive Characteristics

